



Date:

Director  
Department of Engineering and Environmental Services  
P.O. Box 31109  
Shreveport, La 71130

Re: Application for Water Services for

Dear Sir:

I am herewith requesting that I be granted the authority to make a connection to the City of Shreveport's water and/or sewer mains to serve my property which I own as described above.

I hereby agree to secure all permits and inspections required by the Shreveport comprehensive Building Code, all in accordance with the provisions of Section 94-8, "Compliance with building code" and 94-9, "Water and Sewer Outside City- Request for Annexation" of the Code of Ordinances of the City of Shreveport as stipulated below.

Sec. 94-8 All new buildings or structures located within or outside the corporate city limits, and any addition modifications, alterations or repairs of existing buildings that utilize the water or sewer facilities of the city, shall comply with the requirements of the city comprehensive building code as amended, including the securing of all permits and inspections required by such code. (Code 1971, Section 37-1; Ord. No. 112, 1992, Section 37-8, 8-11-92)

Sec. 94-9 Water or Sewer service outside City- Request for Annexation.

(a) As a condition precedent to the initial connection into the city water or sewer line, or both, the application for the water or sewer connection must be accompanied by a written request for annexation to the city, and approved by the City Council.

(b) If, at any time the initial request for connection is made and the written request for annexation is submitted, the area upon which said facility is located is not contiguous

with the city limits or otherwise not legally available for annexation, the owner of the property shall enter into a contract with the city, to be approved by the City Council, which contract shall provide that the property owner shall not withdraw the written request for annexation: that the written request for annexation shall be kept in full force and effect until such time as said area becomes legally available for annexation, and that if the annexation request is withdrawn the facility shall be disconnected from city water and /or sewer service(s). The contract shall be recorded in the conveyance records of Caddo Parish or Bossier Parish Louisiana as the case may be, and may not be assigned without approval of the City Council.

(c) If the area is acquired by a new owner, the new owner shall within 90 days of acquiring the property, submit a written request for annexation of the area to the city and execute a contract as specified in this section to be approved by the City Council. If no such request or contract is received within the time specified, the area shall be disconnected from city water or sewerage service.

I further agree to fully comply with all regulations and requirements set forth by the Department of Engineering and Environmental Services, all in accordance with Section 94-10, "Same Property to be subject to other city regulations" of the City of Shreveport Code of Ordinances follows:

Sec. 94-10      No water or sewer service shall be furnished to persons or property outside or beyond the limits of the city except the full and complete compliance by persons or property with all regulations and requirements of all departments of the city, including but not limited to street, drainage and subdivision regulations (Code 1971, Section 37-3; Ord. No. 112, 1992, Section 37-10, 8-11-92).

Pursuant to Section 94-10 of the City code, attached herewith is my petition for annexation.

I fully understand that this request cannot be approved until the Building Director certifies that the requirements specified in the aforementioned Code of Ordinances have been satisfied.

Yours very truly,

X Joan E. Homa  
2036 PEPPER RIDGE DR.  
797-5957

CRR

Attachment: Petition for Annexation

APPROVED:

---

Director, Department of Engineering and Environmental Services

xc: Office of Water & Sewerage/Field Operations  
Office of Water & Sewerage/Customer Service

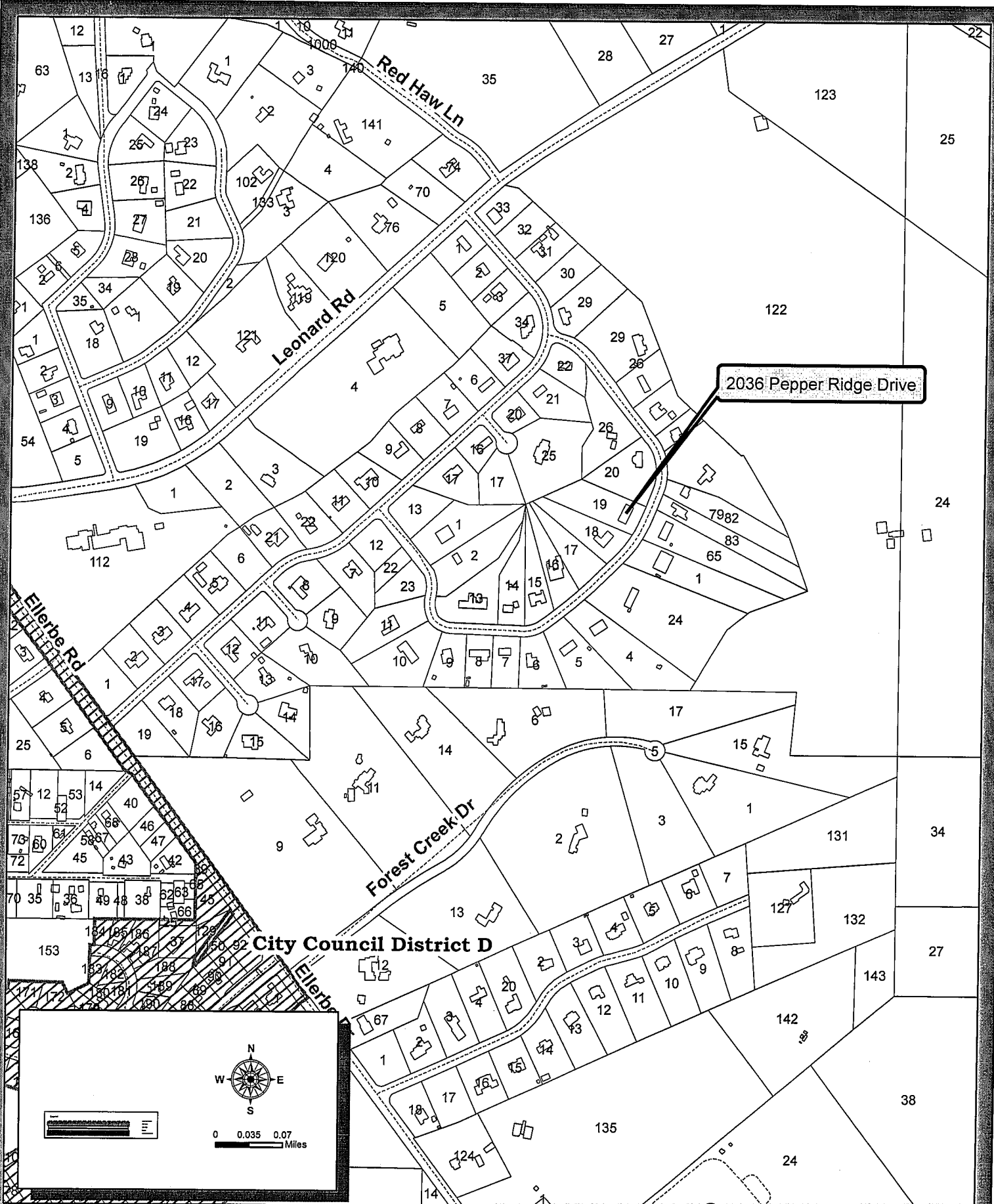

2036 Pepper Ridge Drive

City Council District D

City of Shreveport  
Office of The City Engineer

Copyright 2007. The City of Shreveport assumes no responsibility or legal liability for the accuracy, completeness, reliability, timeliness, or usefulness of any information available on this map. For more up-to-date parcel information visit Caddo Assessor's Office.